

# HUNTERS<sup>®</sup>

HERE TO GET *you* THERE



## Thrawl Street

London, E1 6RW

£3,450 Per Calendar Month



Nestled in the heart of Shoreditch and Spitalfields, this charming 2-bedroom, 2-bathroom warehouse conversion on Thrawl Street marries historical character with modern comfort.

### Key Features:

**Exposed Brickwork:** The striking exposed brickwork throughout the apartment beautifully marries the building's industrial past with contemporary living, adding a unique and warm character to the space.

**Open-Plan Living:** The open-plan living area is thoughtfully designed for both style and practicality, offering ample room for relaxation and social gatherings.

**Gourmet Kitchen:** The well-appointed kitchen boasts modern fixtures and fittings, making it an ideal space for culinary enthusiasts.



Area Map



Floor Plans

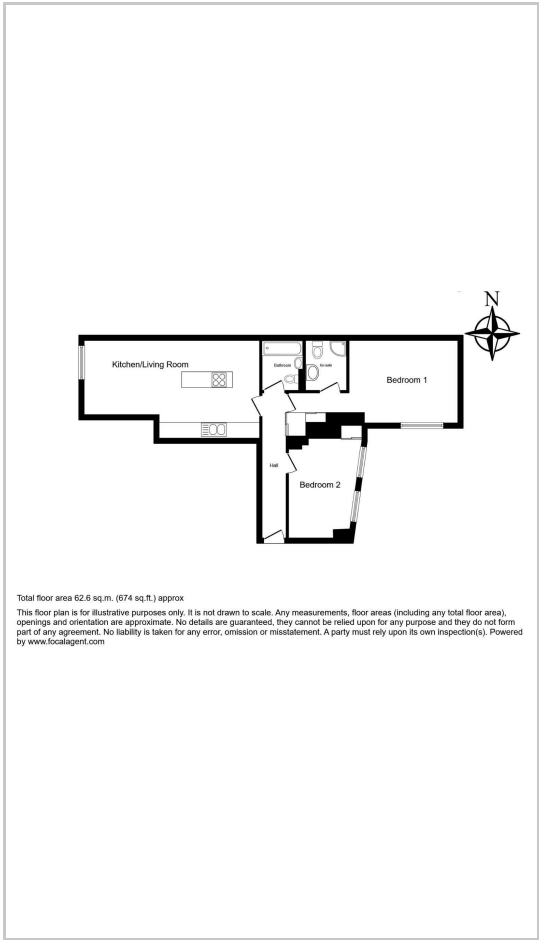

Energy Efficiency Graph

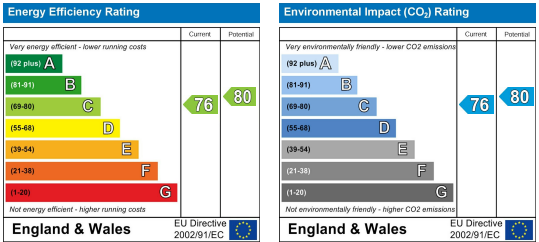

These particulars are intended to give a fair and reliable description of the property but no responsibility for any inaccuracy or error can be accepted and do not constitute an offer or contract. We have not tested any services or appliances (including central heating if fitted) referred to in these particulars and the purchasers are advised to satisfy themselves as to the working order and condition. If a property is unoccupied at any time there may be reconnection charges for any switched off/disconnected or drained services or appliances - All measurements are approximate.

**THINKING OF SELLING?** If you are thinking of selling your home or just curious to discover the value of your property, Hunters would be pleased to provide free, no obligation sales and marketing advice. Even if your home is outside the area covered by our local offices we can arrange a Market Appraisal through our national network of Hunters estate agents.